

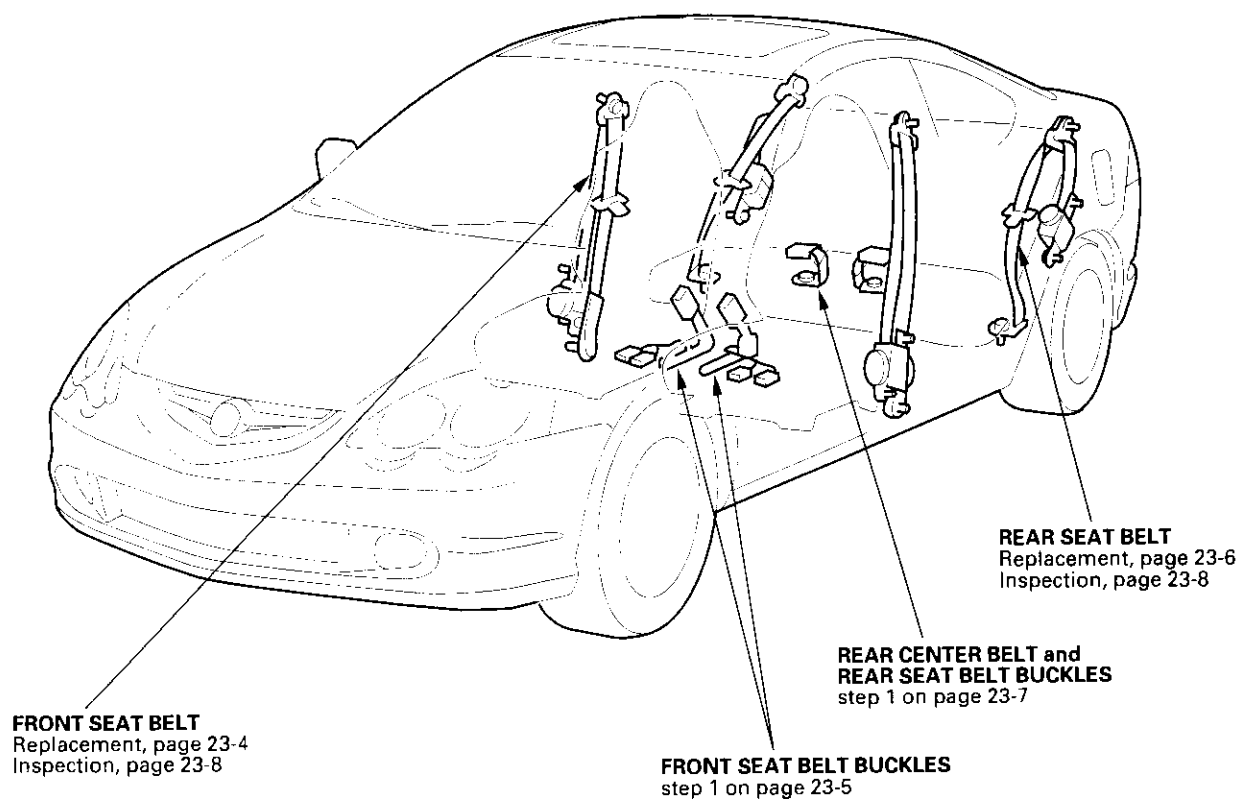

Seat Belts

Component Location Index



Seat Belts

Front Seat Belt Replacement

SRS components are located in this area. Review the SRS component locations (see page 23-10) and the precautions and procedures (see page 23-11) in the SRS section before performing repairs or service.

NOTE: Check the front seat belts for damage, and replace them if necessary. Be careful not to damage them during removal and installation.

Front Seat Belt

1. Make sure you have the anti-theft code for the radio, then write down the frequencies for the preset buttons.
2. Disconnect the negative cable from the battery, and wait at least 3 minutes before beginning work.
3. Slide the front seat forward fully.
4. Remove the rear side trim panel (see page 20-50).
5. Remove the lower anchor cap (A), and remove the lower anchor bolt (B).

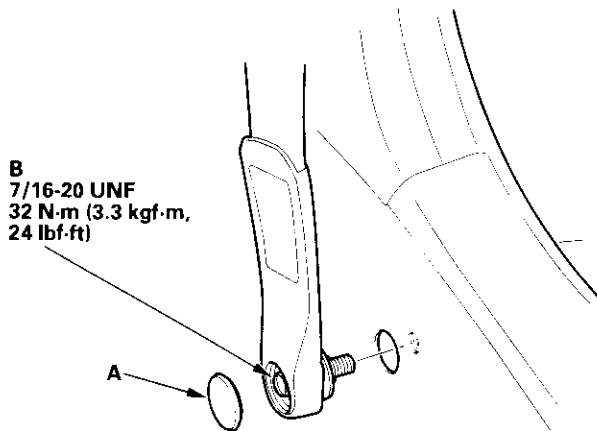

6. Remove the upper anchor cap (A), and remove the upper anchor bolt (B).

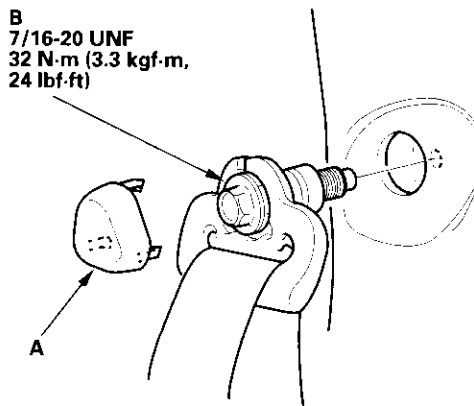

7. Disconnect the seat belt tensioner connector (A). Remove the retractor mounting self-tapping ET screw (B) and the retractor bolt (C), then remove the front seat belt (D) and retractor (E).

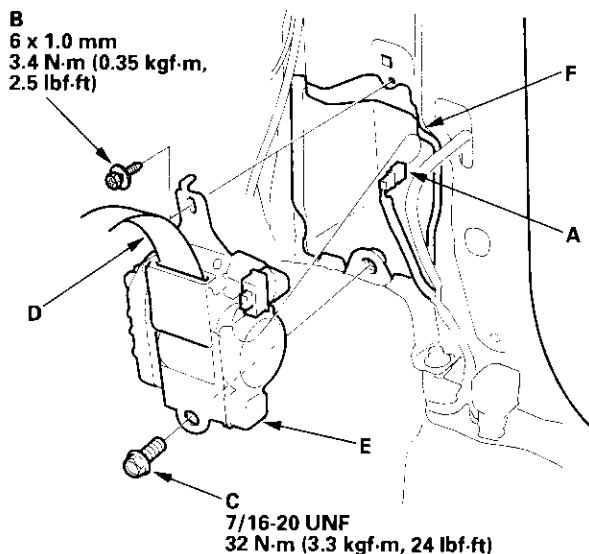

8. If necessary, remove the front seat belt protector (F).



9. Install the belt in the reverse order of removal, and note these items:

- If the threads on the retractor mounting self-tapping ET screw are worn out, use an oversized self-tapping ET screw (P/N 90133-SZ4-0030) made specifically for this application.
- Apply liquid thread lock to the anchor bolts before reinstallation.
- Check that the retractor locking mechanism functions (see page 23-8).
- Assemble the washers, collars, and bushing on the upper and lower anchor bolts as shown.
- If the seat belt tensioner has been deployed, replace the front seat belt protector with a new one.
- Before installing the anchor bolts, make sure there are no twists or kinks in the front seat belt.
- Make sure the seat belt tensioner connector is plugged in properly.
- Reconnect the negative cable to the battery.
- Enter the anti-theft code for the radio, then enter the customer's radio station presets.
- Reset the clock.
- Do the ECM/PCM idle learn procedure (see page 11-149).

Upper anchor bolt construction:

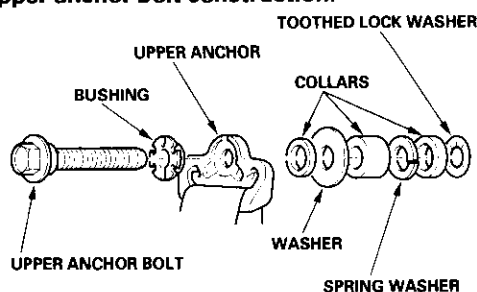

Lower anchor bolt construction:

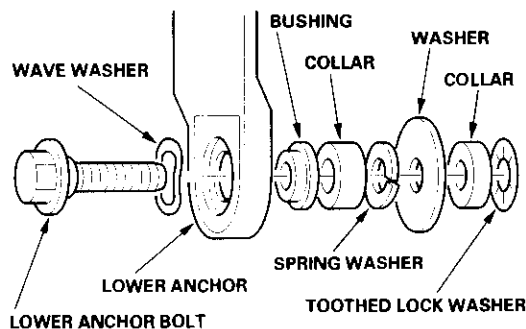

Seat Belt Buckle

1. Make sure you have the anti-theft code for the radio, then write down the frequencies for the preset buttons.
2. Disconnect the negative cable from the battery, and wait at least 3 minutes before beginning work.
3. Remove the front seat (see page 20-72).
4. On the passenger's seat with BOSE sound system, remove the front stereo amplifier (see page 22-113).
5. Detach the seat belt switch connector clip (A) and seat belt buckle tensioner connector clip (B), and on the passenger's seat with BOSE sound system, disconnect the sub-harness connector (C) from the seat belt switch connector. Remove the harness band (D) from the seat cushion frame spring (E). The driver's seat and passenger's seat with BOSE sound system are shown, the passenger's seat without BOSE sound system is similar with the driver's seat.

Driver's seat:

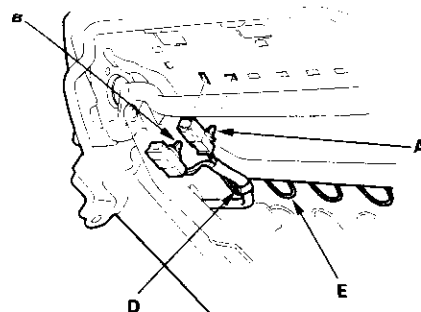

Passenger's seat with BOSE sound system:

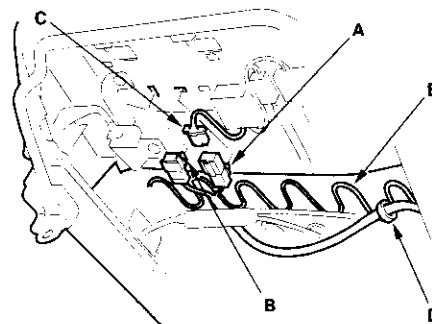

(cont'd)

Seat Belts

Front Seat Belt Replacement (cont'd)

6. Remove the center anchor bolt (A), and remove the seat belt buckle (B).

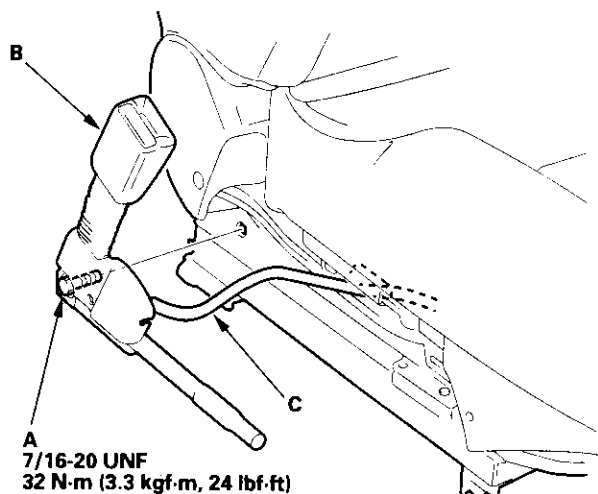

7. Pull the seat belt switch/tensioner harness (C) out through the hole on the seat track.

8. Install the buckle in the reverse order of removal, and note these items:

- Apply liquid thread lock to the center anchor bolt before reinstallation.
- If the seat belt tensioner has been deployed, replace the front seat belt protector with a new one.
- Apply liquid thread lock to the seat mounting bolts before reinstallation.
- Reconnect the negative cable to the battery.
- Enter the anti-theft code for the radio, then enter the customer's radio station presets.
- Reset the clock.
- Do the ECM/PCM idle learn procedure (see page 11-149).

Rear Seat Belt Replacement

NOTE: Check the rear seat belts for damage, and replace them if necessary. Be careful not to damage them during removal and installation.

Rear Seat Belt

1. Remove the rear side trim panel (see page 20-50).
2. Remove the lower anchor bolt (A).

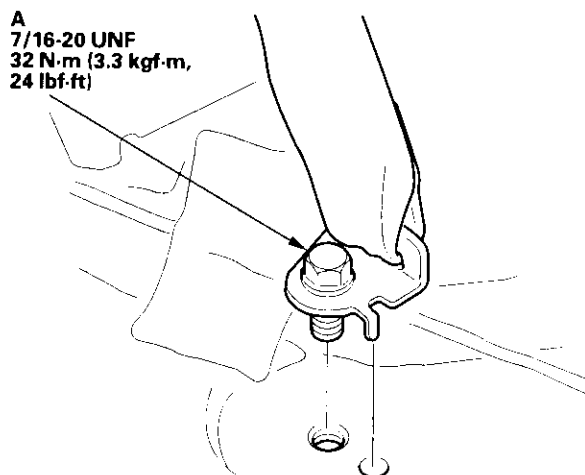

3. Remove the upper anchor cap (A), and remove the upper anchor bolt (B).

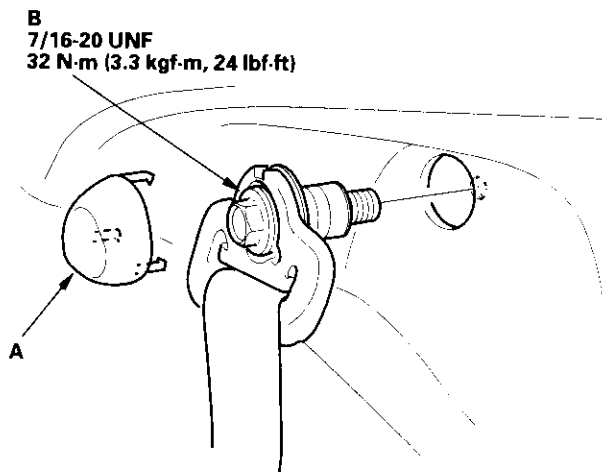



4. Remove the quarter pillar trim as necessary (see page 20-51).
5. Remove the retractor mounting bolt (A) and the retractor bolt (B), then remove the rear seat belt (C) and retractor (D).

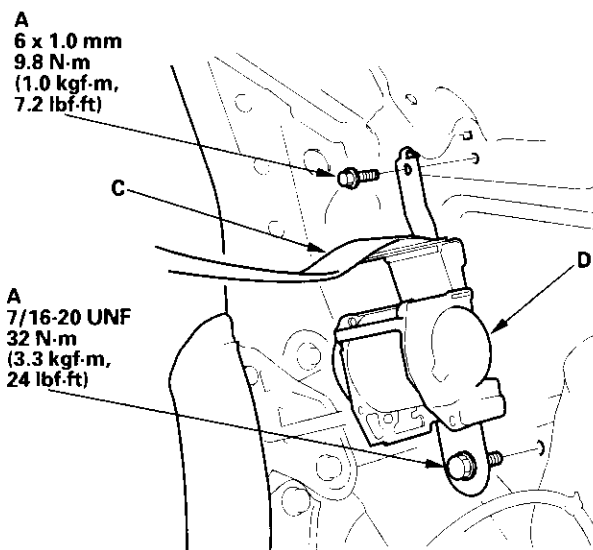

6. Install the belt in the reverse order of removal, and note these items:
- Apply liquid thread lock to the anchor bolts before reinstallation.
 - Check that the retractor locking mechanism functions as described (see page 23-8).
 - Assemble the washers, collars, and bushing on the upper anchor bolt as shown.
 - Before installing the anchor bolt, make sure there are no twists or kinks in the rear seat belt.

Upper anchor bolt construction:

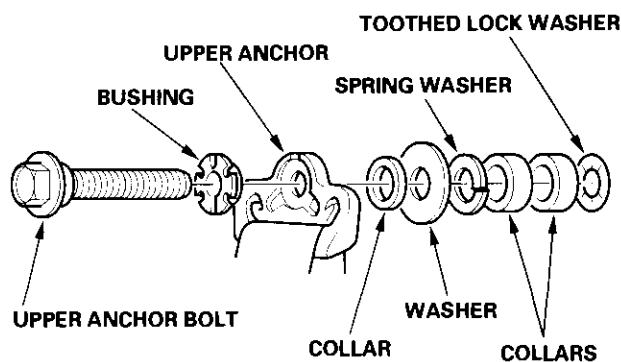

Seat Belt Buckles

1. Remove the rear seat cushion (see page 20-82).
2. Remove the center anchor bolts (A), and remove the seat belt buckles (B).

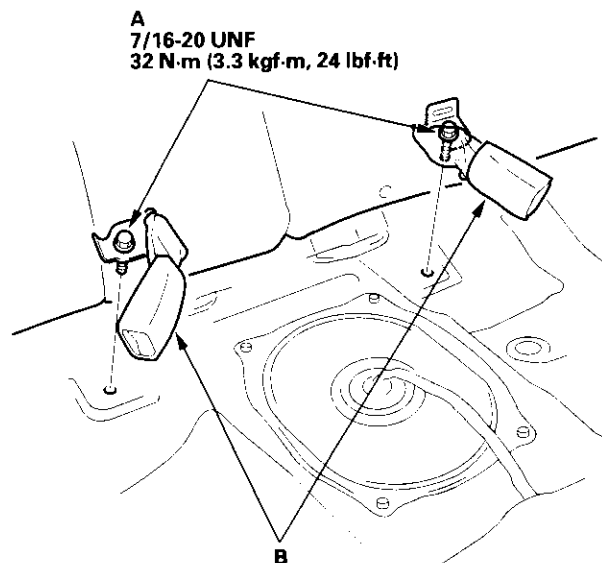

3. Install the buckles in the reverse order of removal, and apply liquid thread lock to the anchor bolts before reinstallation.

Seat Belts

Inspection

For front seat belt retractor with seat belt tensioner, review the SRS component locations (see page 23-10) and the precautions and procedures (see page 23-11) in the SRS section before performing repairs or service.

Retractor

1. Before installing the retractor, check that the seat belt can be pulled out freely.
2. Make sure that the seat belt does not lock when the retractor (A) is leaned slowly up to 15° from the mounted position. The seat belt should lock when the retractor is leaned over 40°. Do not attempt to disassemble the retractor.

Front:

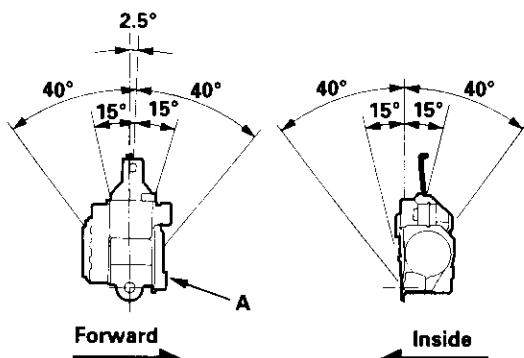

Rear:

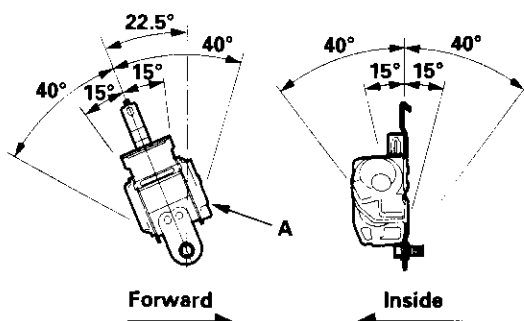

3. Replace the seat belt with a new assembly if there is any abnormality. Do not disassemble any part of the seat belt for any reason.

In-vehicle

1. Check that the seat belt is not twisted or caught on anything.
2. After installing the anchors, check for free movement on the anchor bolts. If necessary, remove the anchor bolts and check that the washers and other parts are not damaged or improperly installed.

3. Check the seat belts for damage or discoloration. Clean with a shop towel if necessary. Use only soap and water to clean.

NOTE: Dirt build-up in the loops of the upper anchors can cause the seat belts to retract slowly. Wipe the inside of the loops with a clean cloth dampened in isopropyl alcohol.

4. Check that the seat belt does not lock when pulled out slowly. The seat belt is designed to lock only during a sudden stop or impact.
5. Make sure that the seat belt will retract automatically when released.
6. For each passenger's seat belt, check the seat belt retractor locking mechanism ALR (automatic locking retractor). This function is for securing child seats.
 - 1 Pull the seat belt all the way out to engage the ALR. The seat belt should retract with a ratcheting sound, but not extend. This is normal.
 - 2 To disengage the ALR, release the seat belt and allow it to fully retract, then pull the seat belt out part-way. The seat belt should retract and extend normally.
7. Replace the seat belt with a new assembly if there is any abnormality. Do not disassemble any part of the seat belt for any reason.



Child Seat Tether Anchor Removal/Installation

1. Open the child seat tether anchor cap (A) in the trunk side trim panel (B).

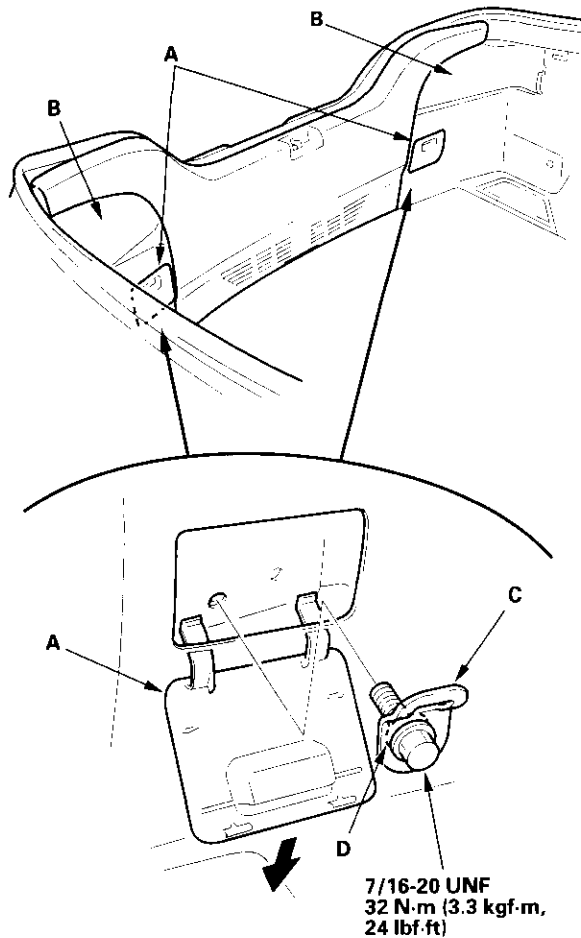

2. Remove the child seat tether anchor (C). Do not remove the toothed washer (D) from the tether anchor.
3. Install the anchor in the reverse order of removal.